

Program of Events

Please retain this information for your visit. Note – *due to limited space, you must have registered in advance to participate in an event, except* for the Thursday Seminar, by Dr. Ed Harvey.

Thursday, Sept. 21

- **Reception/Meet and Greet** “No-host bar”

Lafayette Brewing Company
622 Main. St., Lafayette 6:00 - 8:00 PM

Beer Hall—2nd floor (street parking and paid parking in garage on 5th street)
For more detailed parking information, please click here: <https://goo.gl/BwospV>

Friday, Sept. 22

- **Golf Scramble**

West Lafayette Golf & Country Club – 3224 US-52, West Lafayette
8:00 AM – 1:00 PM / Shot gun start at 8:00 AM

*Please provide any team member requests to patsheetz@att.net no later than Sept. 15, 2017.

- **Campus Geocache Hunt**

EAPS/HAMP Building
550 Stadium Mall Drive, West Lafayette 9:00 –11:30 AM

You will need a smartphone or other GPS-enabled device to participate.
Please check-in at the designated tent in the outdoor patio (NW corner of HAMP Bldg.). The first 50 registrants to finish the geocache hunt will receive a commemorative gift!

- **Geophysical Luncheon**

Lafayette Brewing Company
622 Main St., Lafayette 11:00 AM – 1:00 PM

Lunch provided at no cost to registrants—generously sponsored by Mark Longacre, Mark Lester, and Bill Hinze

Friday, Sept. 22

- **Open House**

EAPS/HAMP Building
550 Stadium Mall Drive, West Lafayette 1:00-3:00 PM

Check-in at designated tent in outdoor patio (NW corner of HAMP Bldg.)

Note-due to safety protocols, children may not be admitted on all lab tours.
Refreshments provided for registrants of Open House in HAMP 2201.

- **Walk Back to the Future**

EAPS/HAMP Building

550 Stadium Mall Drive, West Lafayette 1:00-3:30 PM

Check-in at the designated tent in outdoor patio (NW corner of HAMP Bldg.).
Take a photo at each stop to show at the registration tent and receive a commemorative gift (limited to first 50 registrants).

- **Anniversary Gala Dinner and Reception**

Four Points by Sheraton hotel

1600 Cumberland Ave., West Lafayette

5:30-8:30 PM *Check-in between 5:30 – 6:20 PM

Location - Grand Ballroom

Attire - Business Casual

Saturday, Sept. 23

- **EAPS Tailgate Party**

Purdue University

850 Beering Drive, West Lafayette 1:00-3:00 PM

The location of the EAPS tent will be on the North end of Rankin Track & Field.
See map provided below.

Further information can be found here: <https://goo.gl/18AvAZ>

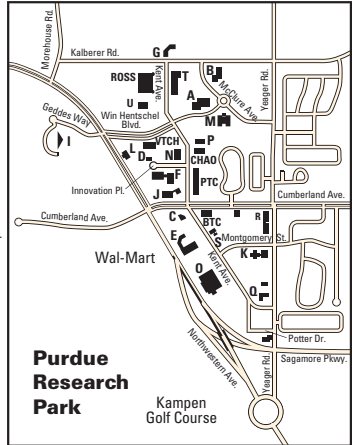

EAPS Tailgate Party

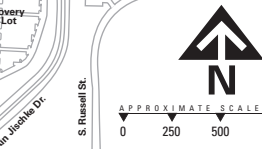

- LEGEND**
- ▲ Emergency phones at street level
 - ◆ Emergency phones in subwalks and garages
 - One-way street
 - Parking garages are permit-only during weekdays, and usually free and open to the public evenings and weekends. (PGMD is residence hall permit-only; PGG has paid visitor parking.)
 - Residence facilities
 - Under construction

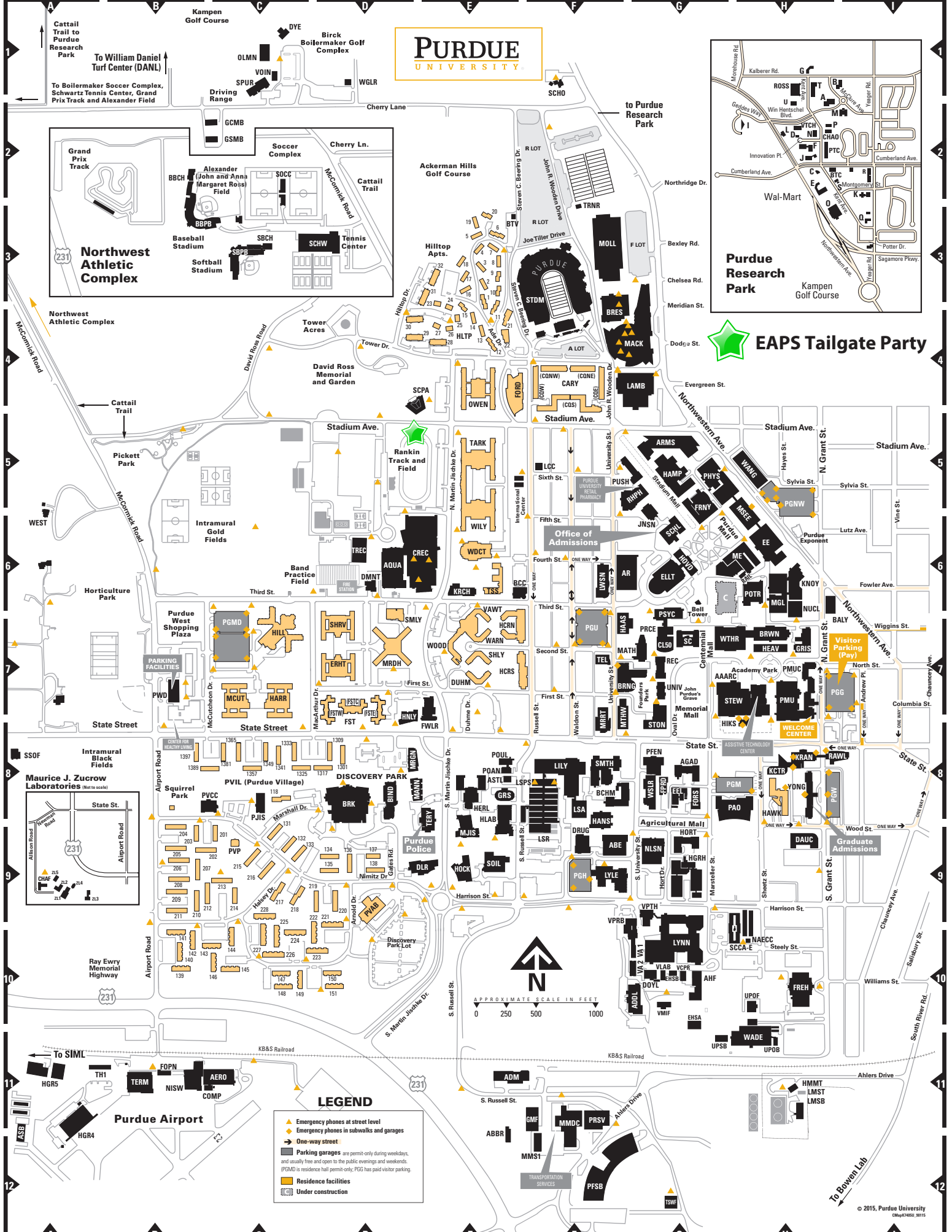

■ Asian American and Asian Resource and Cultural Center (STEW) **G, H7**
ABE Agricultural and Biological Engineering **F9**
ADDL Animal Disease Diagnostic Laboratory **G10**
ADM ADM Agricultural Innovation Center **E11**
AERO Aerospace Science Laboratory **C11**
AGAD Agricultural Administration Building **G8**
AHF Animal Holding Facility **G10**
AQUA Boilermaker Aquatic Center **D6**
AR Armory **G6**
ARMS Armstrong (Neil) Hall of Engineering **G5**
ASB Airport Service Building (Shop Services) **A11-12**
ASTL Animal Sciences Teaching Laboratory **E8**
BALY Bailey (Ralph and Bettye) Hall **H6-7**
BCC Black Cultural Center **F6**
BCHM Biochemistry Building **F8**
BIND Bindley Bioscience Center **D8**
BRES Brees (Drew and Brittany) Student-Athlete Academic Center **F3**
BRK Birk Nanotechnology Center **D8**
BRNG Beering (Steven C.) Hall of Liberal Arts and Education **F, G7**
BRWN Brown (Herbert C.) Laboratory of Chemistry **H7**
BTV Boiler Television Building **E3**
 ■ Car/Van Rentals and Charter Bus (MMDC) **F11**
 † **CHAF** Chaffee Hall **A9**
CL50 Class of 1950 Lecture Hall **G7**
COMP Composites Laboratory **C11**
CREC Córdoba (France A.) Recreational Sports Center **D, E6**
 † **DANL** Daniel (William H.) Turfgrass Research Center **B1**
DAUC Dauch (Dick and Sandy) Alumni Center **H9**
DLR Hall for Discovery and Learning Research **E9**
DMNT DeMent (Clayton W.) Fire Station **D6**
DOYL Doyle (Leo Philip) Laboratory **G10**
DRUG Drug Discovery **F9**
DYE Pete Dye Clubhouse **C1**
EE Electrical Engineering Building **H6**
EEL Entomology Environmental Laboratory **G8**
EHSA Equine Health Sciences Annex **G10**
EHSB Equine Health Sciences Building **G10**
ELLT Elliott (Edward C.) Hall of Music **G6**
EXPT Exponent Building **H6**
FOPN Flight Operations Building **B11**
FORS Forestry Building **G8**
FPRD Forest Products Building **G8**
FREH Freehafer (Lytle J.) Hall of Administrative Services **H10**
FRNY Forney Hall of Chemical Engineering **G5**
FWLR Fowler (Harriet O. and James M., Jr.) Memorial House **E7**
GCMB Golf Course Maintenance Barn **C2**
GMF Grounds Maintenance Facility **F11**
 ■ The Graduate School (Young Hall - first floor) **H8**
 ■ Grand Prix Track (see Northwest Athletic Complex Inset)
GRIS Grissom Hall **H7**
GRS Grounds Service Building **E8**
G SMB Golf Storage Maintenance Building **C2**
HAAS Haas (Felix) Hall **G7**
HAMP Hampton (Delon and Elizabeth) Hall of Civil Engineering **G5**
HANS Hansen (Arthur G.) Life Sciences Research Building **F8, 9**
HEAV Heavilon Hall **H7**
HERL Herrick Acoustics **E8**
HGR4-6 Hangars, Numbers 4 through 6 **A11, 12**
HGRH Horticultural Greenhouse **G9**
HIKS Hicks (John W.) Undergraduate Library **G, H7, 8**
HLAB Herrick Laboratories **E8-9**
HMMT Hazardous Materials Management Trailer **H11**
HNLY Hanley (Bill and Sally) Hall **C7**
HOCK Hockmeyer (Wayne T. and Mary T.) Hall of Structural Biology **E9**
HORT Horticulture Building **G9**
HOVD Hovde (Frederick L.) Hall of Administration **G6**
JNSN Johnson (Helen R.) Hall of Nursing **G5, 6**
KCTR Krannert Center for Executive Education and Research **H8**
KNOY Knoy (Maurice G.) Hall of Technology **H6**
KRAN Krannert Building **H8**
KRCH Krach Leadership Center **E6**
LAMB Lambert (Ward L.) Fieldhouse and Gymnasium **F, G4**
LCC Latino Cultural Center (600 Russell St.) **F5**
 ■ Library, Main (see HIKS) **G, H7, 8**
 ■ Lilly Hall of Life Sciences **F8**
LMSB Laboratory Materials Storage Building **H11**

LMST Laboratory Materials Storage Trailer **H11**
LSA Life Science Animal Building **F8**
LSPS Life Science Plant and Soils Laboratory **F8**
LSR Life Science Ranges (Greenhouse and Service Building) **F8, 9**
LWSN Lawson (Richard and Patricia) Computer Science Building **F6**
LYLE Lyles-Porter Hall **F9**
LYNN Lynn (Charles J.) Hall of Veterinary Medicine **G10**
MACK Mackey (Guy J.) Arena **F, G4**
MANN Mann (Gerald D. and Edna E.) Hall **E8**
MATH Mathematical Sciences Building **G7**
ME Mechanical Engineering Building **G, H6**
MGL Michael Golden Engineering Laboratories and Shops **H6**
MJIS Jischke (Martin C.) Hall of Biomedical Engineering **E9**
MMDC Materials Management and Distribution Center **F11**
MMS1 Materials Management Storage Building 1 **F12**
MOLL Mollenkopf Athletic Center **F3**
MRGN Morgan (Burton D.) Center for Entrepreneurship **E8**
MRRT Marriott Hall **F7, 8**
MSEE Materials and Electrical Engineering Building **H5, 6**
MTHW Matthews Hall **F7, 8**
NAECC Native American Educational and Cultural Center (South Campus Courts, Building B) **H10**
NISW Niswonger Aviation Technology Building **B11**
NLSN Nelson (Philip E.) Hall of Food Science **G9**
NUCL Nuclear Engineering Building **H6**
OLMN Ollman (Melvin L.) Golfcart Barn **C1**
 ■ Parking Facilities (Purdue West, Building D) **B7**
PAO Pao (Yue-Kong) Hall of Visual and Performing Arts **H8**
PFEH Pfendler (David C.) Hall of Agriculture **G8**
PFSB Physical Facilities Service Building **F12**
 ■ Pharmacy (Purdue University Retail Pharmacy - RHPH) **F, G5**
PHYS Physics Building **G5**
PJIS Jischke (Patty) Early Care and Education Center **C8**
PMU Purdue Memorial Union (includes Welcome Center) **H7**
PMUC Purdue Memorial Union Club **H7**
POAN Poultry Science Annex **E8**
POTR Potter (A.A.) Engineering Center **H6**
POUL Poultry Science Building **E8**
PRCE Peirce Hall **G7**
PRSV Printing Services Facility **F11**
PSYC Psychological Sciences Building **G6, 7**
PUSH Purdue University Student Health Center **F, G5**
PVAV Purdue Village Administration Building **D9**
PVCC Purdue Village Community Center **C8**
PWD Parking Facilities **B7**
RAIL American Railway Building **H6**
RAWL Rawls (Jerry S.) Hall **H8**
REC Recitation Building **G7**
RHPH Heine (Robert E.) Pharmacy Building **F, G5**
SC Stanley Coulter Hall **G7**
SCCA-E South Campus Courts, Buildings A-E **G, H9, 10**
SCHL Schleman (Helen B.) Hall of Student Services **G6**
SCHO Global Policy Research Institute (Schowe House) **F1**
SCPA Slayter Center of Performing Arts **D4**
SHIML Holleman-Niswonger Simulator Center
 † **SMLY** Smalley (John C.) Center for Housing and Food Services Administration **D6, 7**
SMTH Smith Hall **F8**
SOIL Soil Erosion Laboratory, National **E9**
SPUR Spurgeon (Tom) Golf Training Center **C1**
SSOF State Street Office Facility **A8**
STDM Ross-Ade Stadium (includes Ross-Ade Pavilion [RAP]) **F3**
STEW Stewart Center **G, H7**
STON Stone (Winthrop E.) Hall **G7, 8**
 ■ Student Health Center (see PUSH) **F, G5**
TEL Telecommunications Building **F7**
TERM Terminal Building **B11**
TERY Terry (Oliver P.) House **E8, 9**
TH1-6 Tee-Hangars 1 through 6 **A11**
TREC Turf Recreation Exercise Center **D6**
TSWF Transportation Service Wash Facility **G12**
UNIV University Hall **G7**
UPOB Utility Plant Office Building **H11**
UPOF Utility Plant Office Facility **H10**
UPSB Utility Plant Storage Building **G11**
VA1 Veterinary Animal Isolation Building 1 **G10**
VA2 Veterinary Animal Isolation Building 2 **G10**
VCPR Veterinary Center for Paralysis Research **G10**

■ Visitor Information Center (now the Welcome Center — east end of PMU) **H7**
VLAB Veterinary Laboratory Animal Building **G10**
VMIF Veterinary Medicine Isolation Facility **G10**
VOIN Voinoff (Samuel) Golf Pavilion **C1**
VPRB Veterinary Pathobiology Research Building **F, G9, 10**
VPTH Veterinary Pathology Building **G9**
WADE Wade (Walter W.) Utility Plant **H11**
WANG Wang (Seng-Liang) Hall **H5**
 ■ Welcome Center (see PMU) **H7**
WEST Westwood (President's Home) **A5, 6**
WGLR Women's Golf Locker Room **D1**
WSLR Whistler (Roy L.) Hall of Agricultural Research **G8**
WTHR Wetherill (Richard Benbridge) Laboratory of Chemistry **G, H7**
YONG Young (Ernest C.) Hall **H8**
 † **Z11** Combustion Research Laboratory
 † **Z12** Gas Dynamics Research Laboratory
 † **Z13** High Pressure Research Laboratory
 † **Z14** Propulsion Research Laboratory
 † **Z15** Turbomachinery Fluid Dynamics Laboratory

Residence & Dining Facilities

CARY Cary (Franklin Levering) Quadrangle **F4**
 * **DUHM** Duhme (Ophelia) Residence Hall **E7**
ERHT Earhart (Amelia) Residence Hall **D7**
FORD Ford (Fred and Mary) Dining Court **F4**
FST First Street Towers **D7**
HARR Harrison (Benjamin) Residence Hall **C7**
HAWK Hawkins (George A.) Hall **H8**
HCEN Honors College and Residences North **E7**
HCRS Honors College and Residences South **E7**
HILL Hillenbrand Residence Hall **C7**
HLTP Hilltop Apartments **E3**
MCUT McCutcheon (John T.) Residence Hall **C7**
MRDH Meredith (Virginia C.) Residence Hall **D7**
OWEN Owen (Richard) Residence Hall **E4**
PVAB Purdue Village Administration Building **D9**
PVCC Purdue Village Community Center **C8**
PVIL Purdue Village **B, C, D8, 9, 10**
PVP Purdue Village Preschool **C9**
 * **SHLY** Shealy (Frances M.) Residence Hall **E7**
SHRV Shreve (Eleanor B.) Residence Hall **D6, 7**
SMLY Smalley (John C.) Center for Housing and Food Services Administration **D6, 7**
TARK Tarkington (Newton Booth) Residence Hall **E5**
 Third Street Suites **E6**
TSS Vawter (Everett B.) Residence Hall **E6**
 * **WARN** Warren (Martha E. and Eugene K.) Residence Hall **E7**
WDCT Wiley Dining Court **E6**
WILY Wiley (Harvey W.) Residence Hall **E5, 6**
 * **WOOD** Wood (Elizabeth G. and William R.) Residence Hall **E7**

Northwest Athletic Complex (C2-3 inset)

BBCH Purdue Baseball Clubhouse
BBPB Purdue Baseball Press Box
SBCH Purdue Softball Clubhouse
SBPB Purdue Softball Press Box
SCHW Schwartz (Dennis J. and Mary Lou) Tennis Center
SOCC Purdue Women's Soccer Building

Parking Garages

Parking garages are for permitted parking during weekdays. Parking becomes free and open to the public on most nights and weekends. The Grant Street garage (PGG) has paid visitor parking at all times. **Visitors may purchase day parking passes in advance at www.purdue.edu/parking. Visitor passes are not valid in the Grant Street garage.**

PGG Parking Garage, Grant Street **H, 17**
PGH Parking Garage, Harrison Street **F9**
PGM Parking Garage, Marsteller Street **G, H8**
PGMD Parking Garage, McCutcheon Drive **C6, 7** (residence hall permit required)
PGNW Parking Garage, Northwestern Avenue **H5**
PGU Parking Garage, University Street **F6, 7**
PGW Parking Garage, Wood Street **H8**

* Windsor Residence Halls

† Part of Maurice J. Zucrow Laboratories

‡ Buildings not appearing on map

EAPS Black & Golden Jubilee – Campus Parking Information

On September 21 and 22, paid visitor parking is available in the Grant Street Parking Garage (PGG). The Northwestern Parking Garage (PGNW) does not contain spaces for visitor parking. Two-hour parking is also available throughout campus on surrounding side streets. After 5 p.m. and before 7 a.m., parking in all parking garages is free of charge.

Please keep in mind that [CityBus](#), the local bus service, does serve the campus area, as well as the ride-sharing services [Uber](#) and [Lyft](#). If you are parking at PGG and would rather not walk across campus, we would recommend taking the [Silver Loop \(13\)](#). There are bus stops at the Purdue Memorial Union (PMU), as well as the Physics Building (PHYS) and Armstrong Hall (ARMS), both of which are very close to Hampton Hall (HAMP), where the EAPS Department is located. See the map below for bus stops. This bus also has a stop at the Stewart Center (STEW), which is very close to the Wilmeth Active Learning Center (WALC), the location of Thursday's special seminar.

Purdue is currently undertaking a large construction project on State Street. Work on State Street in the area shown in the map is scheduled to be completed by the time of the Jubilee. However, we urge registrants to check the [Purdue Physical Facilities website](#) prior to coming, in case there are delays in the completion of the project. For all parking information related to the Homecoming Football Game on Saturday, visit the [Purdue Sports website](#).

